

## Patient Information



### Important information about the packaging: Optimisation of shape and separability

Quality means continuously improving. We work closely with our customers, partners and suppliers and regularly check how our quality is assessed by customers. We have received advice in recent weeks on how we can optimise our product packaging. This is valuable feedback for us that we have immediately addressed.

This means: In the first step, we optimised separability of the individual blisters from each other. Stronger perforation minimises the likelihood of damaging the film of the adjacent blister when opening one blister. Rounded packaging edges favour more comfortable handling in the future.

We are already working intensively on developing the packaging concept to further improve its application in the medium term.

### How does instillation work?

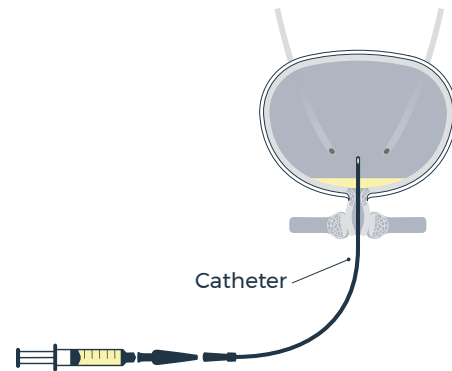

If your doctor prescribes a medicine for instillation in a pre-filled syringe, you will receive two prescriptions:

- one prescription for the **syringe** with instillation solution
- a second prescription for the **adapter** that connects the syringe to the catheter

### How do you prepare the instillation?

Have everything you need for instillation ready before catheterisation:

- Pre-filled syringe
- Handling adapter
- Disinfectant
- Catheters and other materials for catheterisation

Before instillation, the bladder should have been completely emptied via a catheter. Be careful not to touch the syringe and the adapter directly so that both remain sterile. We recommend that you prepare the syringe before catheterisation.



Should you have any further questions, please ring our **patient hotline on: +49 (0)221 791 014 160**  
Business hours: Mon.–Fri. 8 a.m.–6 p.m.

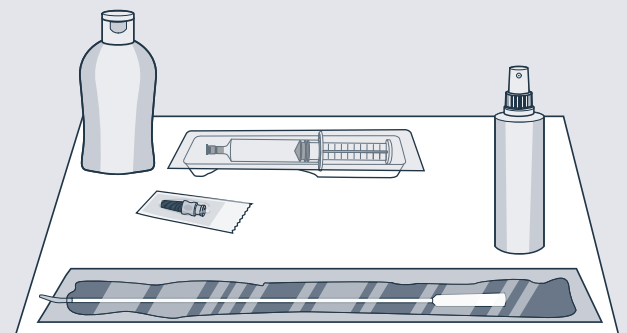

The following instructions can be found as a video at:  
[www.farco.de/en/adapter](http://www.farco.de/en/adapter)

# Instructions on handling the syringe and adapter

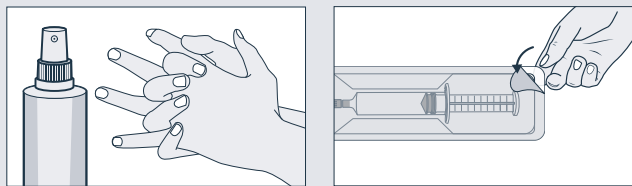

**1)** Disinfect your hands as indicated on the packaging of the disinfectant. Open the packaging of the **pre-filled syringe** at the spot marked for this purpose.

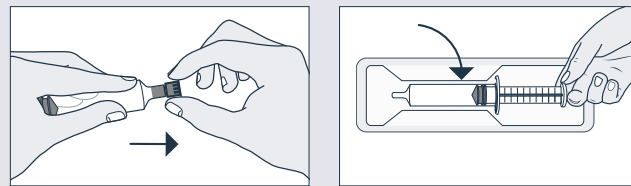

**2)** Remove the pre-filled syringe from the packaging. Remove the cap by turning it slightly, and place the pre-filled syringe back into the packaging.

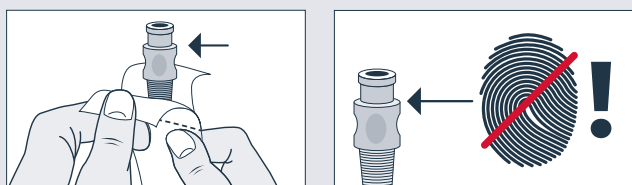

**3)** Open the packaging of the adapter halfway at the spot marked for this purpose. Be careful not to touch the adapter.

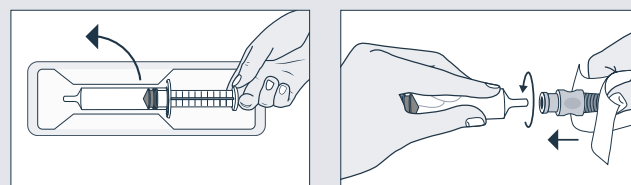

**4)** Take the pre-filled syringe out of the packaging again. Hold the pre-filled syringe by the cylinder while screwing the adapter onto the syringe. Make sure that the adapter is firmly in place. Next remove the packaging.

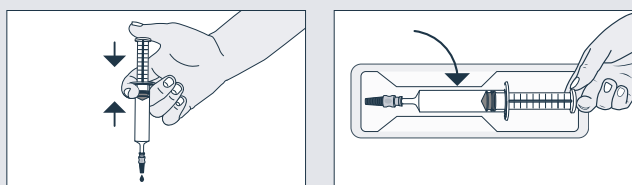

**5) TIP:** If you were prescribed less than the amount in the syringe, inject out the unneeded amount before instillation.

Now put the syringe with the adapter back into its packaging without touching the adapter.

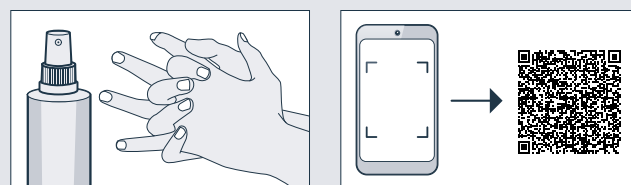

**6)** Disinfect your hands and begin catheterisation. (Instructions can be found at: [www.farco.de/isk](http://www.farco.de/isk)).



**7)** Empty your bladder completely through the catheter and make sure that the catheter is still in the bladder before you start instillation.

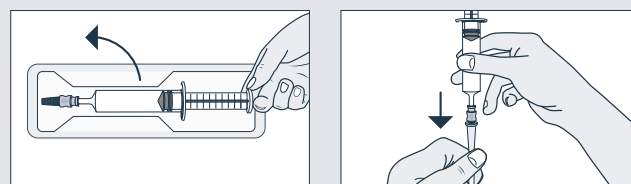

**8)** Take the pre-filled syringe out of the packaging again and connect the adapter to the catheter.

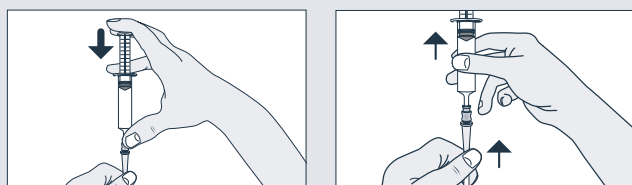

**9)** Instill the contents of the pre-filled syringe into the bladder by pressing the plunger of the syringe. Remove the pre-filled syringe together with the catheter for disposal.

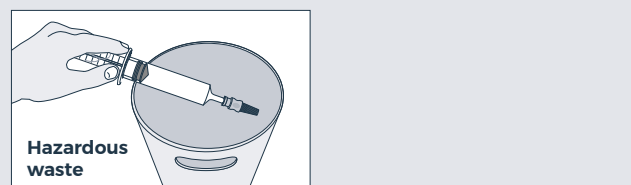

**10)** Unused medicinal product or waste material is to be disposed of in accordance with national requirements. For the sake of the environment, do not dispose of the medicines in waste water.